

FTIP ID# <i>(required)</i> LA0G086				
TCWG Consideration Date February 28, 2023				
Project Description <i>(clearly describe project)</i>				
<p>This project proposes a two-lane flyover off-ramp connector structure (approximately 1,400 feet in length). The structure will connect from the end of the existing viaduct (the Harbor Transitway ExpressLanes or High Occupancy Toll [HOT]) and land at the existing Figueroa Way. Two standard lanes (12 feet in width) will be provided along with a four-foot left shoulder and an eight-foot right shoulder. New column/bent locations will be located at Figueroa Way and in the I-110 mainline.</p> <p>Context sensitive solutions have been considered and will continue to be considered as the proposed project moves into the design phase of the project. As stated in the Visual Impact Assessment (April 2015), the elevated structure will be constructed of concrete and its form defined by crisp lines. Further, the use of texture on the outer bridge railing will be explored in the structure design phase. It is anticipated that the structure color itself will be natural concrete gray. This will match the existing structure. If color is to be used it would be in the way of possible light post or fencing, which will also be explored in the design phase. The composition of the structure and associated facilities will promote a uniform appearance with the existing structure and roadway. Another context sensitive element of the proposed project is to design and implement a pedestrian friendly streetscape in Caltrans right-of-way immediately beneath the flyover (at street grade or “area beneath the flyover”) that includes landscaping and lighting that embraces the West Adams community.</p>				
Type of Project <i>(use Table 1 on instruction sheet)</i>				
New Interchange				
County LA	Narrative Location/Route & Postmiles I-110 at Adams Blvd, Postmile 20.5/20.9			
	Caltrans Projects – EA# 27800			
Lead Agency: Caltrans				
Contact Person Andrew Yoon	Phone# 213.266.6892	Fax# 213.897.1634	Email andrew.yoon@dot.ca.gov	
Hot Spot Pollutant of Concern <i>(check one or both)</i> PM2.5 X PM10 X				
Federal Action for which Project-Level PM Conformity is Needed <i>(check appropriate box)</i>				
Categorical Exclusion (NEPA)	EA or Draft EIS	X FONSI or Final EIS	PS&E or Construction	Other
Scheduled Date of Federal Action: 12/29/2023				
NEPA Assignment – Project Type <i>(check appropriate box)</i>				
Exempt	Section 326 –Categorical Exemption	X	Section 327 – Non-Categorical Exemption	
Current Programming Dates <i>(as appropriate)</i>				
	PE/Environmental	ENG	ROW	CON
Start	July 2012	Dec 2025	Dec 2025	Feb 2028
End	Dec 2023	Feb 2028	July 2027	May 2029

Project Purpose and Need (Summary): *(attach additional sheets as necessary)*

The current terminus of the northbound I-110 ExpressLanes in an off-ramp to Adams Boulevard presents a particularly challenging bottleneck. The existing I-110 ExpressLane facility ends approximately one-half mile south of downtown Los Angeles. Approximately half of the ExpressLane traffic exits through the existing ExpressLane off-ramp to Adams Boulevard to access downtown Los Angeles via Figueroa Street, which results in queuing and congestion of downstream traffic in the ExpressLane off-ramp as well as on the mainline of the freeway. Increasing capacity at this location is the key to ensuring the I-110 ExpressLane facility can manage delay and serve additional users. The purpose of the project is to alleviate congestion and reduce queuing and delay in the ExpressLane mainline and off-ramp.

Surrounding Land Use/Traffic Generators *(especially effect on diesel traffic)*

Land use mostly consists of commercial and residential uses immediately adjacent to the project area, along with manufacturing and public facilities. The Exposition/University Park redevelopment project area is in close proximity to this proposed project. Other development within 500 feet of the project area include church, hospital, daycare center, and children’s school.

Opening Year: Build and No Build LOS, AADT, % and # trucks, truck AADT of proposed facility					
Northbound I-110 HOT Lanes, Opening Year 2027					
Location	Alternative	AADT		Truck AADT	
Proposed HOT Off-Ramp to Figueroa St	Build	8970		0	
HOT Off-Ramp to Adams Bl	No-Build	15088		0	
	Build	8949		0	
Northbound I-110 HOT Lanes, Opening Year 2027					
Intersection	Alternative	Peak Hour LOS		Peak Hour Delay (sec)	
		AM	PM	AM	PM
HOT Off-Ramp & Adams Bl	No-Build	E	F	75	89
	Build	D	E	54	72
Figueroa NB & 23 rd near the Proposed HOT off-ramp	No-Build	B	C	18	21
	Build	C	C	24	21

RTP Horizon Year / Design Year: Build and No Build LOS, AADT, % and # trucks, truck AADT of proposed facility					
Northbound I-110 HOT Lanes, Opening Year 2027					
Location	Alternative	ADT		Truck ADT	
Proposed HOT Off-Ramp to Figueroa St	Build	8917		0	
HOT Off-Ramp to Adams Bl	No-Build	15158		0	
	Build	8526		0	
Northbound I-110 HOT Lanes, Opening Year 2027					
Intersection	Alternative	Peak Hour LOS		Peak Hour Delay (sec)	
		AM	PM	AM	PM
HOT Off-Ramp & Adams Bl	No-Build	E	F	71	93
	Build	D	F	46	83
Figueroa NB & 23 rd near the Proposed HOT off-ramp	No-Build	B	C	20	24
	Build	C	C	28	25
<p>Opening Year: If facility is an interchange(s) or intersection(s), Build and No Build cross-street AADT, % and # trucks, truck AADT</p> <p>RTP Horizon Year / Design Year: If facility is an interchange (s) or intersection(s), Build and No Build cross-street AADT, % and # trucks, truck AADT</p>					
<p>Describe potential traffic redistribution effects of congestion relief (<i>impact on other facilities</i>)</p> <p>The proposed project would help motorists bypass the current bottleneck intersection at Flower/Adams and provide a direct connection from the ExpressLanes (HOT) to Figueroa Street. This would alleviate the queuing and improve the operation and safety of the ExpressLanes facility within the project area. According to the traffic analysis results noted above, the proposed fly-over off-ramp to Figueroa Street would improve the operation at the Adams Blvd intersection while slightly increasing AM delays at the Figueroa St intersection.</p>					

Comments/Explanation/Details *(attach additional sheets as necessary)*

The project is proposed to provide an alternate bypass for the current bottleneck intersections; to reduce the queuing; and to improve the operation and safety of the overall ExpressLanes off-ramp and arterial facilities. According to the traffic data, the proposed project is anticipated to improve the delay and LOS at the existing ExpressLane off-ramp to Adams Boulevard. The projected future ADT for the proposed facility and the arterials in the vicinity are far less than those criteria listed in the 40 CFR 92.123(b)(1) and the facility is not anticipated to carry heavy duty truck traffic. The delay and LOS at several intersections are anticipated to improve as a result of the project. As a result, it is requested for TCWG to concur that the proposed project is not of air quality concern for both PM_{2.5} and PM₁₀.



PROJECT LOCATION MAP

Figure 1: Project Location Map

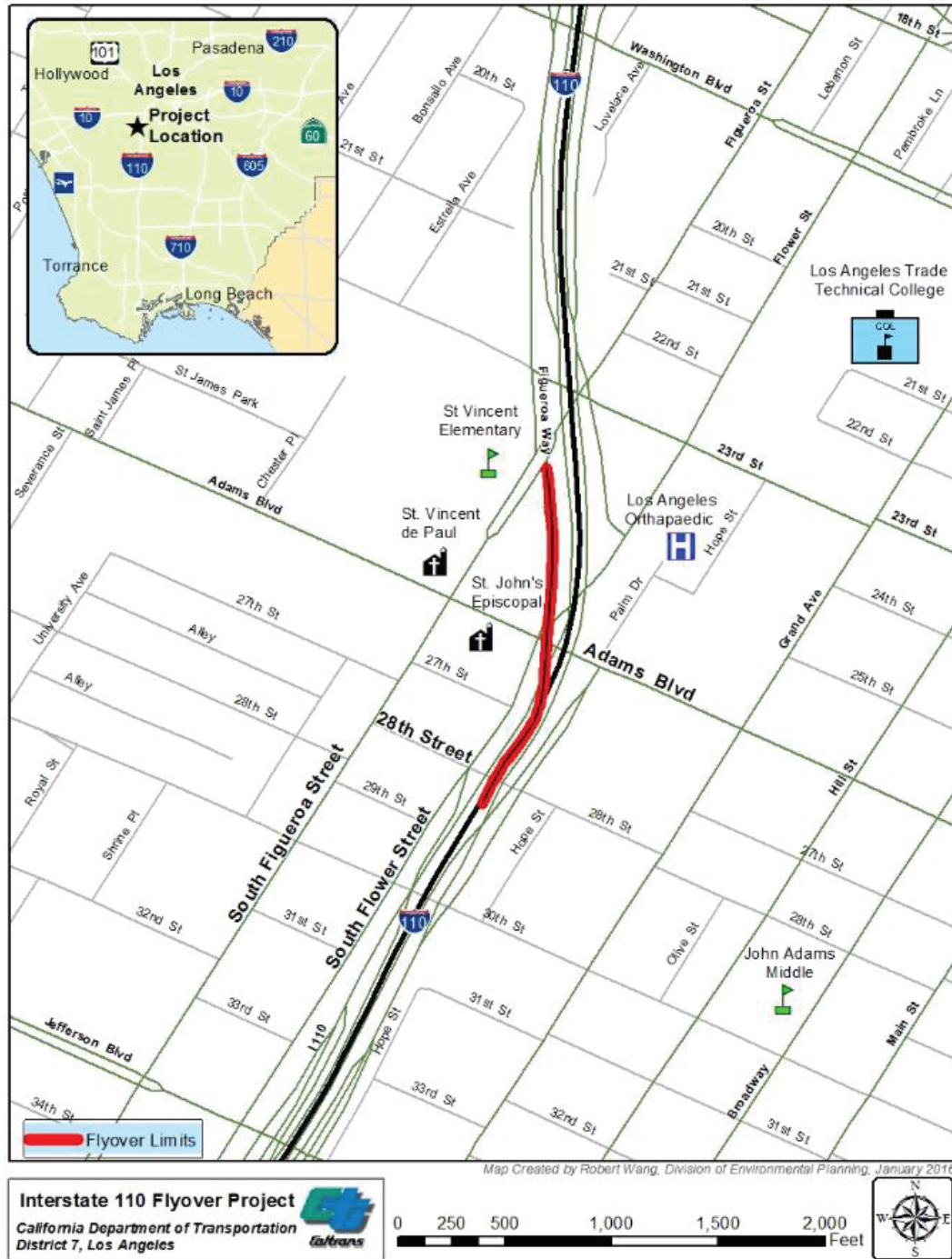
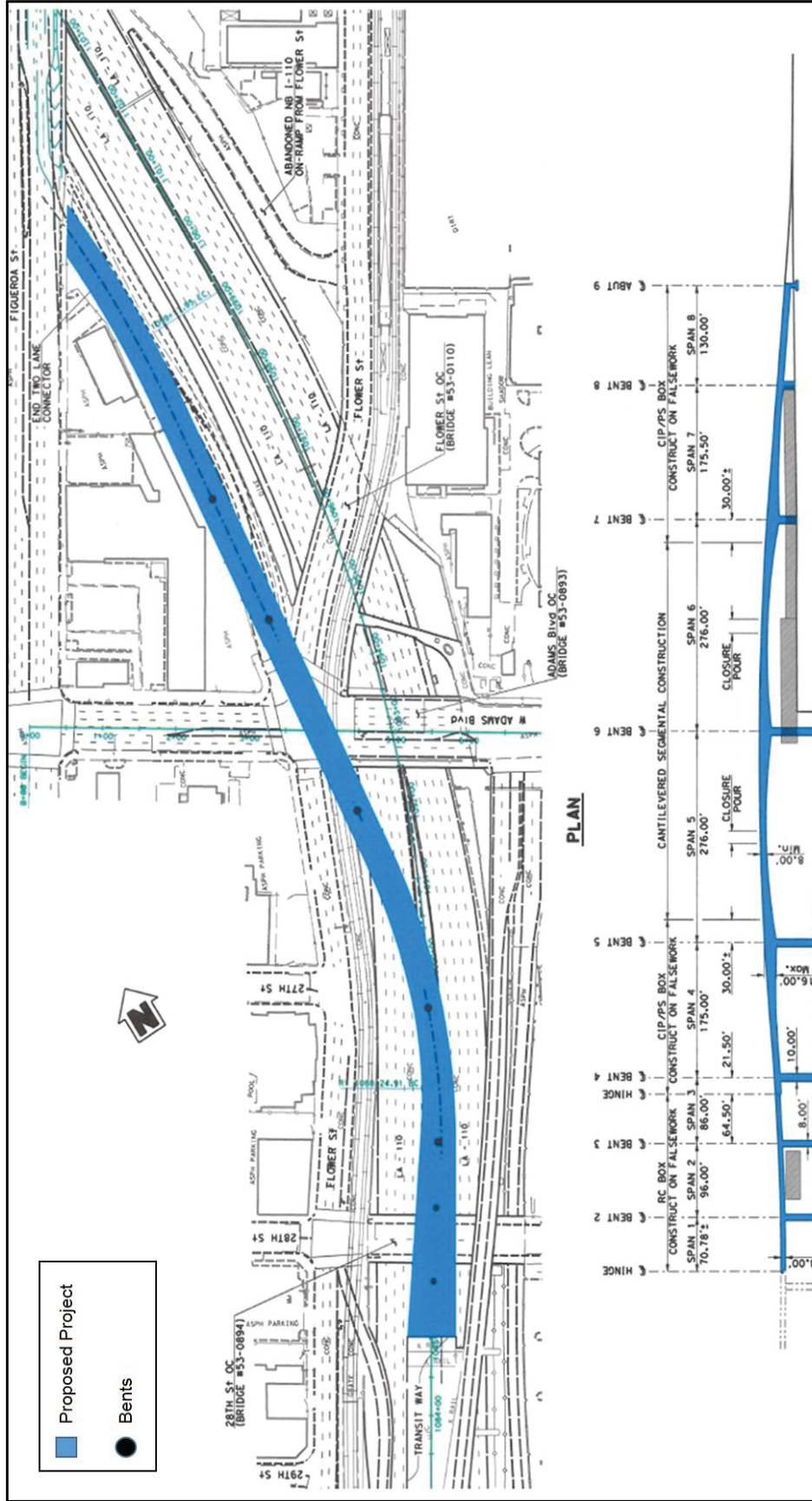

Figure 3: Proposed Project Features Map



Source: Caltrans Structures Unit (January 2016)

CITY OF LOS ANGELES

**END CONSTRUCTION
PM 20.92**

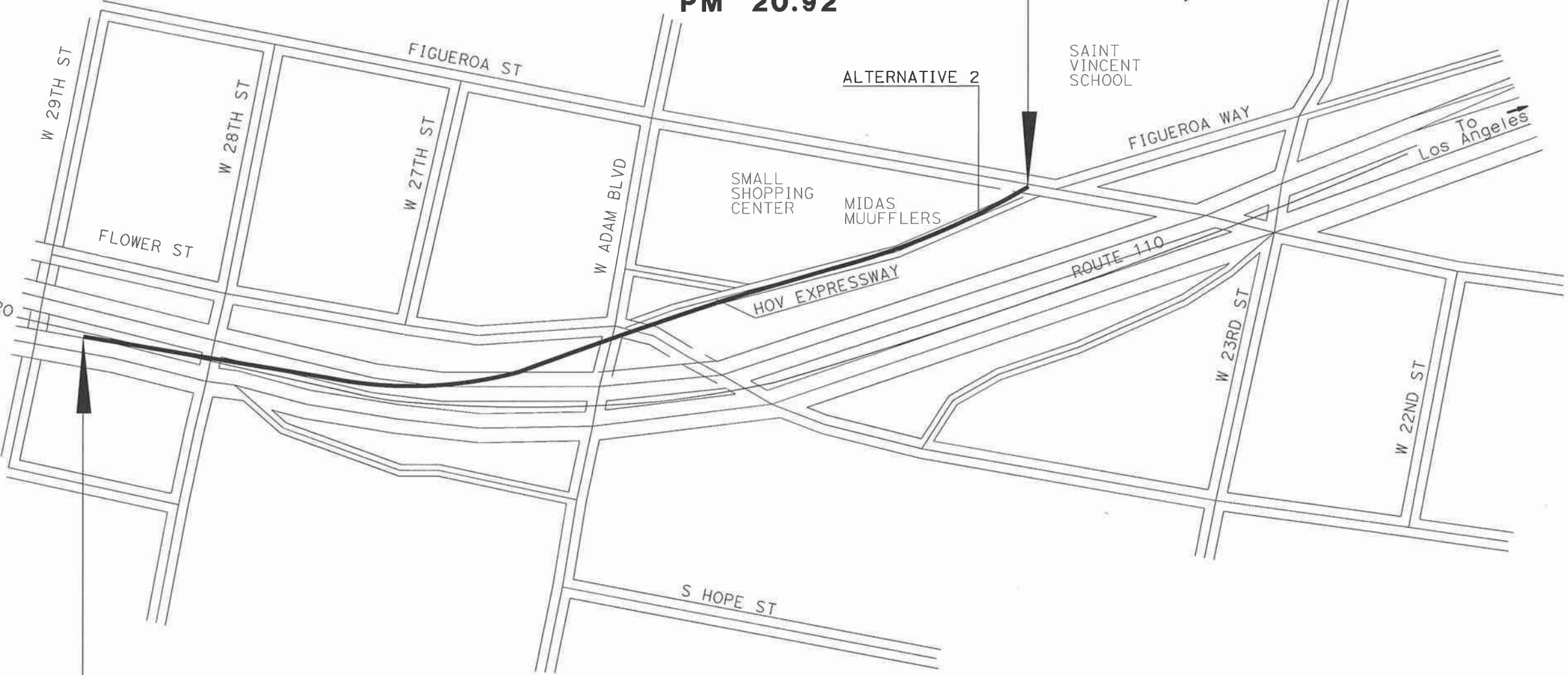

**BEGIN CONSTRUCTION
PM 20.58**

VICINITY MAP

NO SCALE

TO SAN PEDRO

To Los Angeles

Dist	COUNTY	ROUTE	POST MILES TOTAL PROJECT	SHEET No.	TOTAL SHEETS
07	LA	110	20.10/20.92		

REGISTERED CIVIL ENGINEER DATE _____

PLANS APPROVAL DATE _____

THE STATE OF CALIFORNIA OR ITS OFFICERS OR AGENTS SHALL NOT BE RESPONSIBLE FOR THE ACCURACY OR COMPLETENESS OF SCANNED COPIES OF THIS PLAN SHEET.



CURVE DATA

No.	R	Δ	T	L
①	2000'	31°18'48"	560.54'	1093.04'
②	850'	25°57'06"	195.86'	385.00'

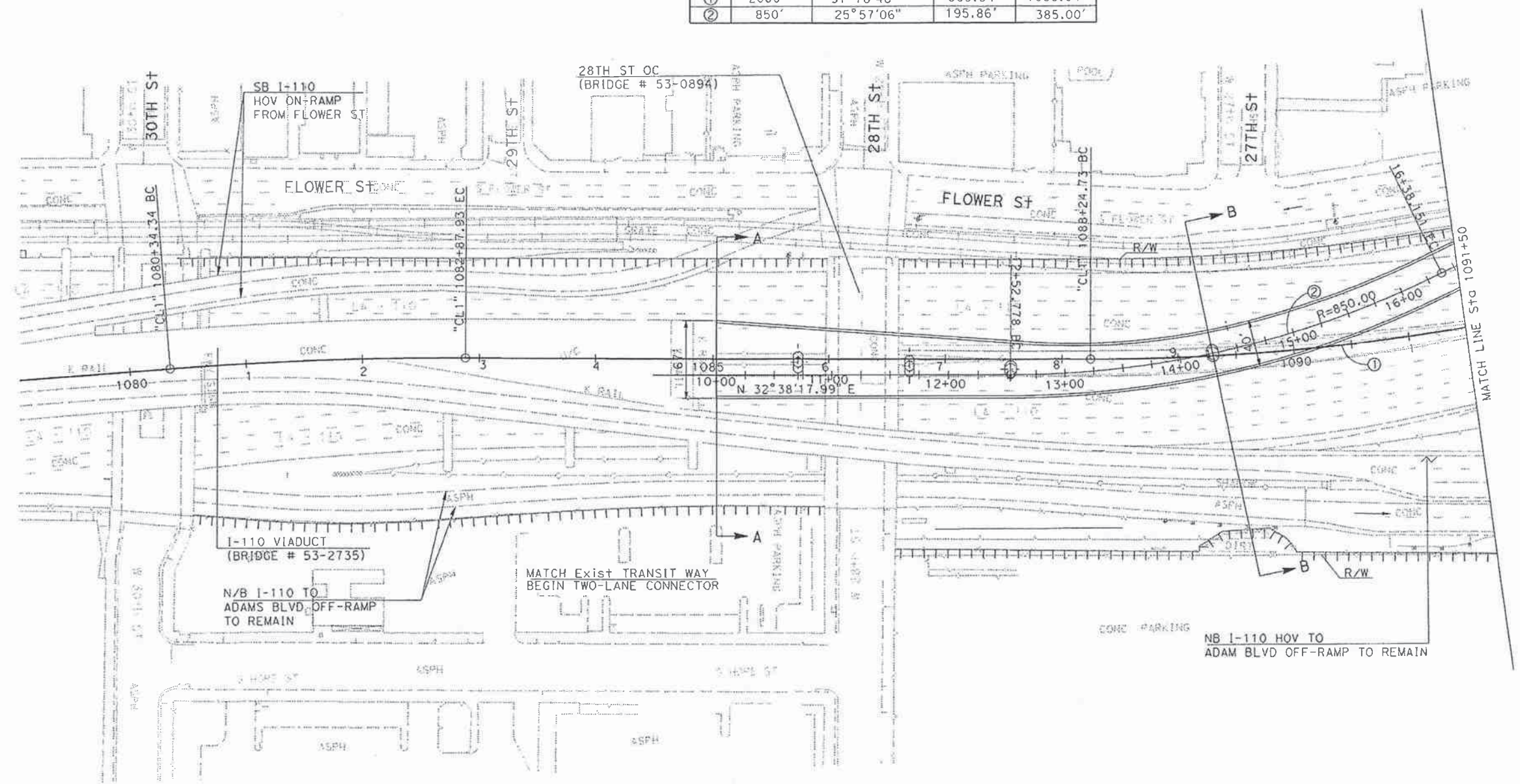

STATE OF CALIFORNIA - DEPARTMENT OF TRANSPORTATION

Caltrans

REVISOR: _____

DATE: _____

DESIGNED BY: _____

CHECKED BY: _____

FUNCTIONAL SUPERVISOR: _____

ALTERNATIVE 2

SCALE: 1" = 50'

L-1

DATE PLOTTED => 24-JUN-2014
TIME PLOTTED => 09:05

Dist	COUNTY	ROUTE	POST MILES TOTAL PROJECT	SHEET No.	TOTAL SHEETS
07	LA	110	20.10/20.92		

REGISTERED CIVIL ENGINEER	DATE
PLANS APPROVAL DATE	

THE STATE OF CALIFORNIA OR ITS OFFICERS OR AGENTS SHALL NOT BE RESPONSIBLE FOR THE ACCURACY OR COMPLETENESS OF SCANNED COPIES OF THIS PLAN SHEET.

No.	R	Δ	T	L
③	1400'	11°39'19"	142.89'	284.79'

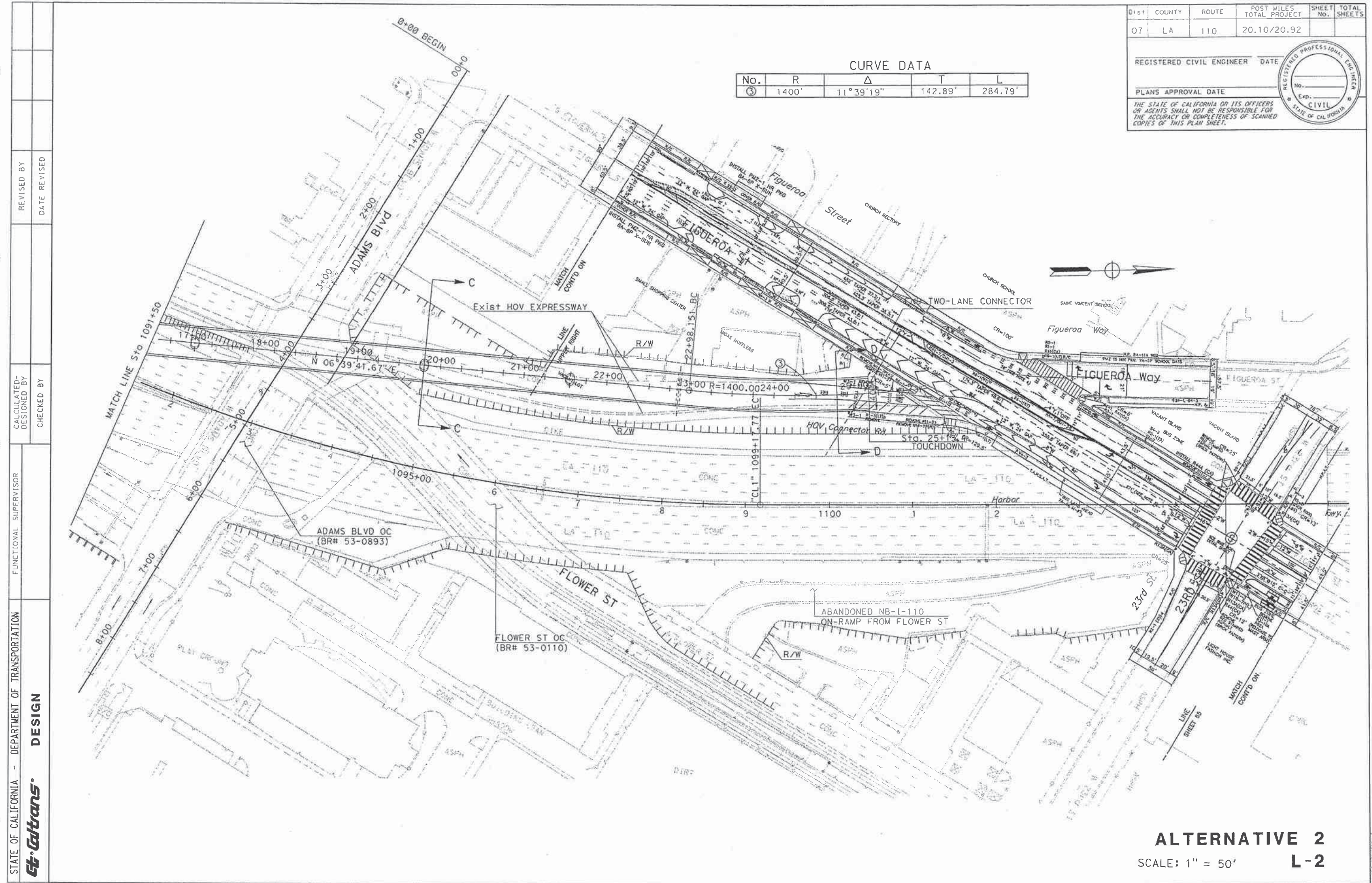

ALTERNATIVE 2
SCALE: 1" = 50'
L-2

STATE OF CALIFORNIA - DEPARTMENT OF TRANSPORTATION	DESIGN
FUNCTIONAL SUPERVISOR	
CHECKED BY	
DESIGNED BY	
DATE REVISED	
REVISOR	

DATE PLOTTED => 24-JUN-2014 00:00:00 TIME PLOTTED => 09:05